

Horizontal barrier from outside

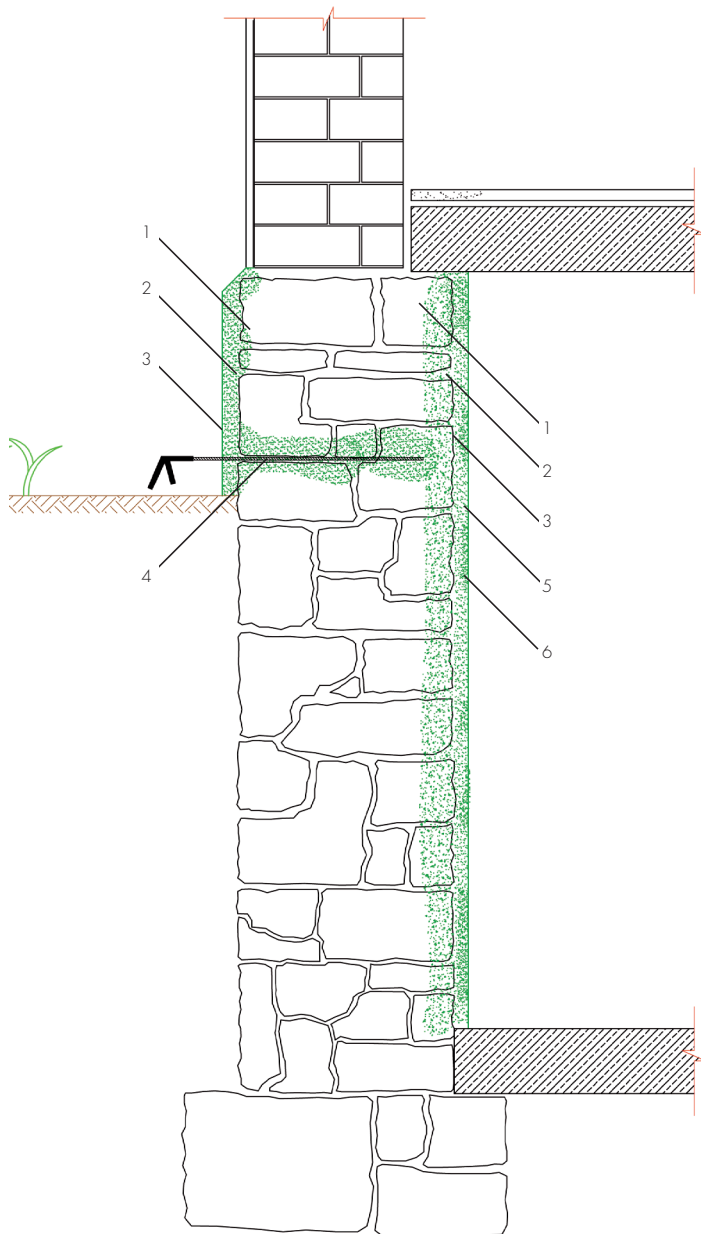

1. Salt treatment with ESCO-FLUAT
 2. Semi-covered rough cast THERMOPAL-SP
 3. Restoration plaster THERMOPAL-SR24 or THERMOPAL-SR44
 4. Horizontal barrier with AQUAFIN-F or AQUAFIN-IB2
- | | |
|----------------------------|-----------------|
| <u>Horizontal barrier:</u> | With pressure: |
| Hole depth: | brick ./ . 5 cm |
| Hole distance: | 10 - 12 cm |
| Height offset: | 8 cm |
5. Fine plaster THERMOPAL-FS33
 6. Silicate paint ADICOR-SK